

# TECHNICAL INFORMATION



PRODUCT

P 1 / 3

**Models No.** ▶ 5017RKB

**Description** ▶ Dustless Circular Saw 190mm

## CONCEPT AND MAIN APPLICATIONS

What provides you dust-free clean work, is the above Model 5017RKB, which is the first dustless circular saw with riving knife in the world.

This model is based on Model 5703R, but equipped with durable and higher power motor of 1,400W.

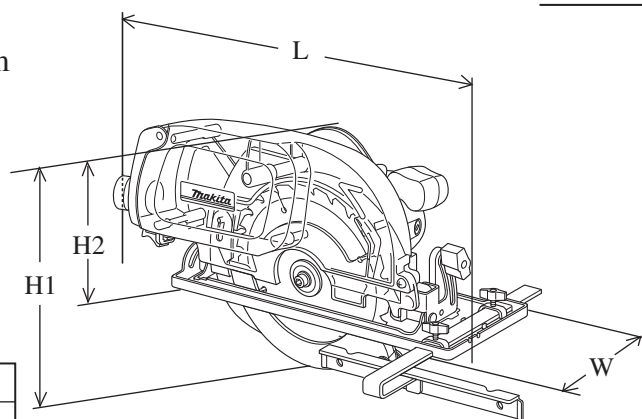

Dimensions : mm ( " )	
Length ( L )	414 (16-1/4)
Height	( H1 ) 254 (10)
	( H2 ) 182 (7-1/8)
Width ( W )	277 (10-7/8)

## ► Specification

Voltage (V)	Current (A)	Cycle (Hz)	Continuous Rating (W)		Max. Output(W)
			Input	Output	
110	13	50/60	1,400	600	1,750
220	6.7	50/60	1,400	600	2,200
230	6.4	50/60	1,400	600	2,200
240	6.1	50/60	1,400	600	2,200

No load speed : rpm.= min.-1	4,800	
Size of blade	Diameter : mm (")	190 (7-1/2)
	Arbor : mm (")	30 (1-3/16)
Max. cutting capacities : mm (")	at 90°	66 (2-5/8)
	at 45°	46 (1-13/16)
Electric brake	No	
Protection from electric shock	by double insulation	
Net weight : Kg (lbs.)	5.5 (12.1)	
Cord length : m (ft)	2.5 (8.2)	

## ► Standard equipment

- \* Rip fence (Guide rule) ..... 1 pc.
- \* Hex wrench 5 ..... 1 pc.
- \* Tungsten carbide tipped saw blade 190mm / 24T..... 1 pc.

<Note> The standard equipment for the tool shown may differ from country to country .

## ► Optional accessories

- \* Various tungsten carbide tipped saw blade 190mm
- \* Inner flange 40 for the saw blade with 20mm hole diameter

## ► Repair

### < 1 > Disassembling ball bearing 608DDW

- (1) Take off countersunk head screw M5 x 16 which is fastening bearing box. Then the gear section can be removed from blade case as illustrated in **Fig. 1**.

**Fig. 1**

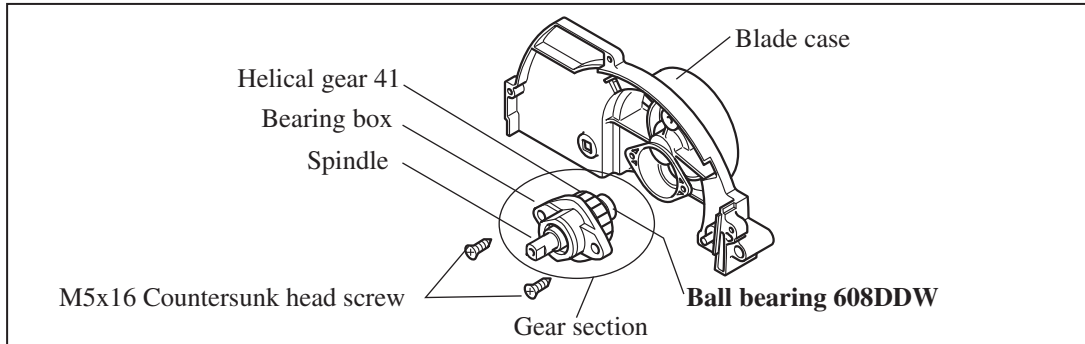

- (2) Hold the above gear section with vice or something. And disassemble ball bearing 608DDW with 2 pcs. of No. 1R263 bearing extractors as illustrated in **Fig. 2**.

**Fig. 2**

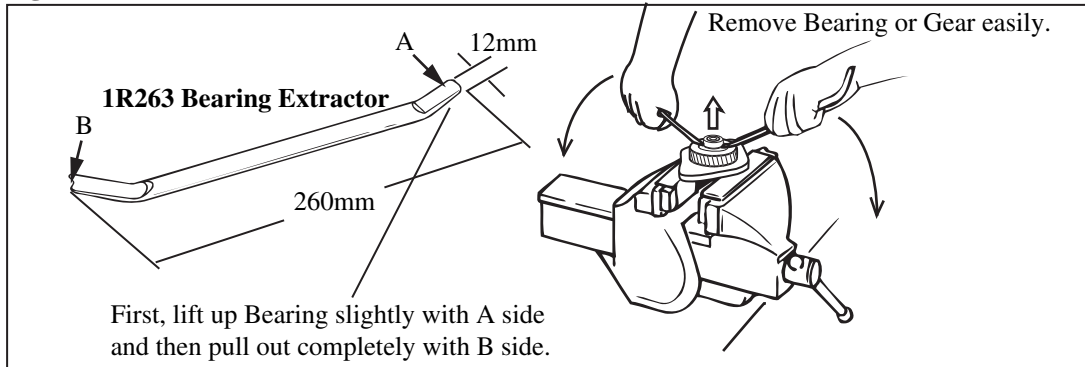

### < 2 > Assembling bearing box

- ( 1 ) For sealing gear section, O ring 44 is assembled to bearing box. Be careful not to do damage to O ring 44, when assembling bearing box ( gear section ) to blade case. (**Fig. 3**)

**Fig. 3**

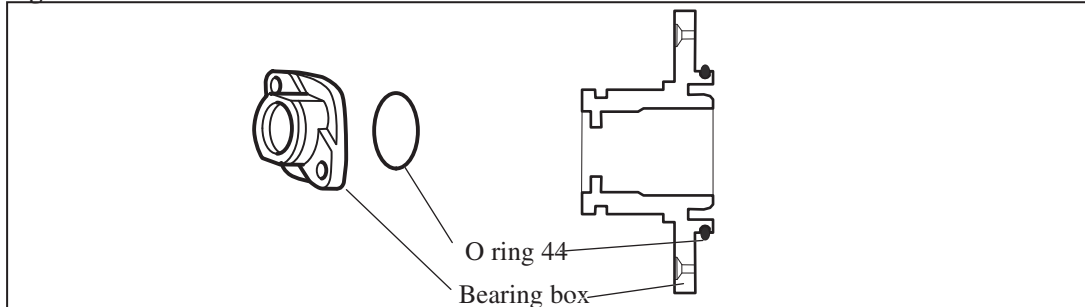

### < 3 > Assembling riving knife

- ( 1 ) Adjust the depth of cut on the max. cutting position. And then, assemble riving knife to the riving knife holder keeping its position against saw blade as illustrated in **Fig. 4**.

**Fig. 4**

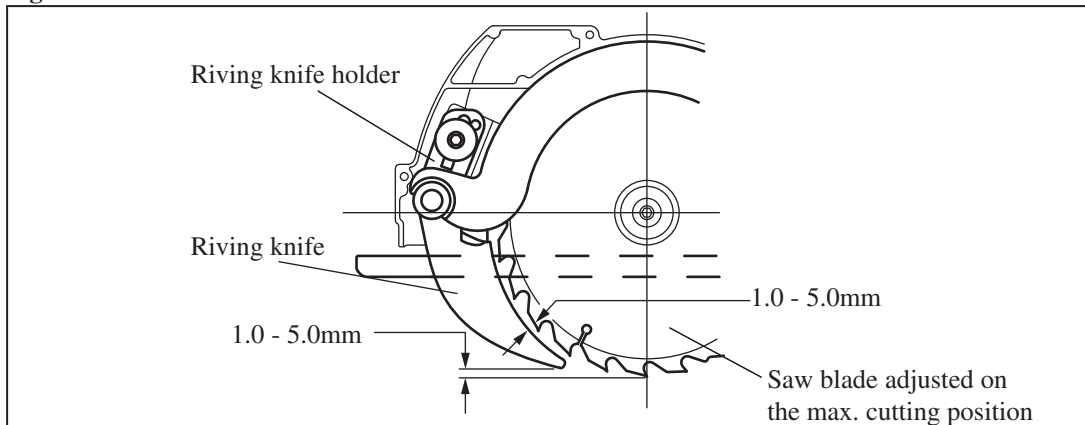

► **Circuit diagram**

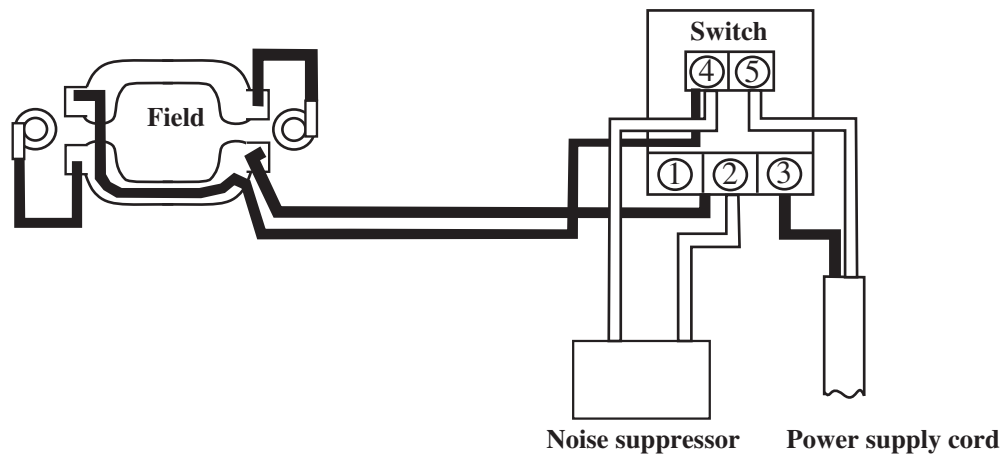

► **Wiring diagram**

