

T ECHNICAL INFORMATION



New Tool

Models No. ▶ 5103R

Description ▶ 270 mm (10-5/8") Circular Saw

CONCEPTION AND MAIN APPLICATIONS

Model 5103R is a redesigned version of the existing Model SR2600.

It is equipped with a riving knife, larger base, more efficient chip/sawdust ejection port, soft-start feature, electric brake, etc.

Guide rail and guide rail adapter are available as optional accessories.

Model 5103R complies with CENELEC Standard.

It is offered to European countries and areas only.

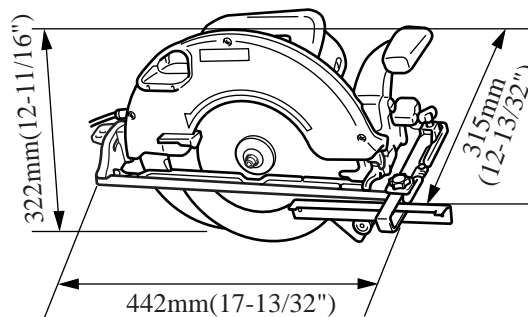

► Specifications

Voltage (V)	Current (A)	Cycle (Hz)	Continuous Rating (W)		Max. Output(W)
			Input	Output	
100	15.0	50/60	1,430	800	2,400
110 (for U.K.)	20.0	50/60	2,100	1,250	2,400
115	15.0	50/60	1,650	900	2,400
220	10.0	50/60	2,100	1,350	3,300
230	9.6	50/60	2,100	1,350	3,300
240	9.2	50/60	2,100	1,350	3,300

Blade diameter	270 mm (10-5/8")	
Arbor diameter	30 mm (1-3/16")	
Max. cutting capacities	At 90°	100 mm (3-15/16")
	At 45°	73 mm (2-7/8")
No load speed	3,800R/min	
Net weight	9.4 kg (20.7 lbs)	

► Standard equipment

Rip fence (guide rule), Hex wrench 6, Carbide-tipped saw blade 270

► Optional accessories

Carbide-tipped saw blade 270, Joint set, Guide rail, Guide rail adapter

The standard equipment for the tools shown may differ from country to country