

# TECHNICAL INFORMATION



New Tool

**Models No.** ▶ 6791D

**Description** ▶ MAKITA Cordless Screw Driver

## CONCEPTION AND MAIN APPLICATIONS

Makita Cordless Screw Driver provides high efficiency function. The driver is stopped by clutch action when screw is tightened and at the same time switch is turned off the electric circuit automatically and brake is applied to stop motor rotation. Then the driver provides small variation in its tightening torque availing battery energy effectively without eliminating energy loss. We also have developed new type battery [DC9000 and DC9100 battery charger are used.] to obtain improved machine balance.

Model 6791D is battery mounted type without charger. Model 6791DW is battery mounted type with charger.

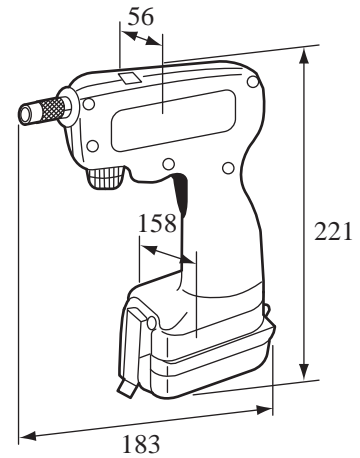

### ▶ Specifications

|                               |   |
|-------------------------------|---|
| <b>DC magnet motor</b>        |   |
| <b>No load speed (R.P.M.)</b> | 400/min   |
| <b>Driver bit</b>             | 6.35 mm hex bit   |
| <b>Function</b>               | Variable torque adjusting<br>Tightening torque value [Minimum 20 kg-cm ~ Maximum 100 kg-cm] |

### ▶ Standard equipment

Phillips bit 2-45, 3-45

### ▶ Optional accessories

Phillips bit 2-45, 2-65, 2-82, 2-110, 2-150, 2-250, 3-45, 3-65, 3-110

Minus bit 5-4.5, 5-82, 6-70, 6.35-45, 8-45, 8-70, 10-52, 10-70, 10-52

Socket bit 7-55, 8-55, 10-55, Makita battery 9100, 12V rapid charger [DC9012] for vehicle

## ► Repairing

### 1. Disassembling

(1) Unscrew when disassembling is made.

Housing can not be disassembled when screws are tightened.

### 2. Wiring diagram

