

# T ECHNICAL INFORMATION



New Tool

**Models No.** ▶ 9227CB

**Description** ▶ 180mm Sander Polisher

## CONCEPTION AND MAIN APPLICATIONS

Model 9227CB is the improved version of the existing Model 9217SPC and its brief benefits are;

- \*Easy for polishing
  - Variable speed control by trigger : 0-3000rpm
  - Variable speed control by dial : 600-3000rpm(wide area)
- \*Loop handle can be gripped easily at various operating position.
- \*Face of pad is velcro type to make replacing buff (wool pad, etc.) easy.
- \*Sanding operation can be performed using rubber pad and abrasive disc (optional accessories).
- \*Electronic speed control feature
  - Less reaction at starting by soft start feature
  - Clean surface by steady speed feature

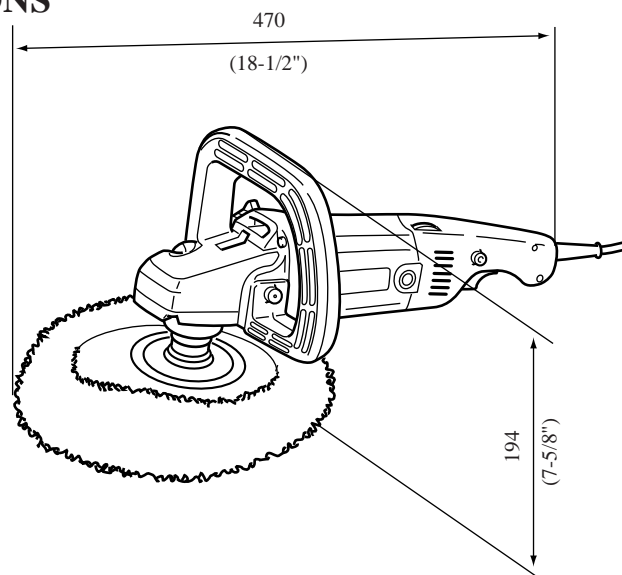

### ► Specifications

Voltage (V)	Current (A)	Cycle (Hz)	Continuous Rating(W)		Max. Output(W)	
			Input	Output		
110	10.0	50/60	1100	580	1600	For U.K.
220	5.7	50/60	1200	710	1800	
230	5.5	50/60	1200	710	1800	
240	5.3	50/60	1200	710	1800	
240	4.8	50/60	1100	580	1800	for U.K.

No Load Speed	0-3000rpm
Diameter of wool pad	180mm (7")
Net Weight	3.0kg (6.6 lbs)
Cord Length	2.5m (8.2 ft)

### ► Standard equipment

- Hex. Wrench 6-----1 pc.
- Wool Pad 180-----1 pc.
- Sleeve 18-----1 pc.
- <Note> The standard equipment may differ from country to country.

### ► Optional accessories

- Abrasive Disc 180-16,20,24,30,50,80,100,120
- Rubber Pad
- Sanding Lock Nut 16-48
- Lock Nut Wrench 28
- Grip 36 Complete
- Wool Pad 180 Set
- Wool Bonnet 180

The standard equipment for the tools shown may differ from country to country.

## ▶ Repair

### (1) Replacing of armature

- 1) Remove the magic pad.
- 2) Remove the carbon brush.
- 3) Remove the tapping screw PT4x18 for holding the handle.

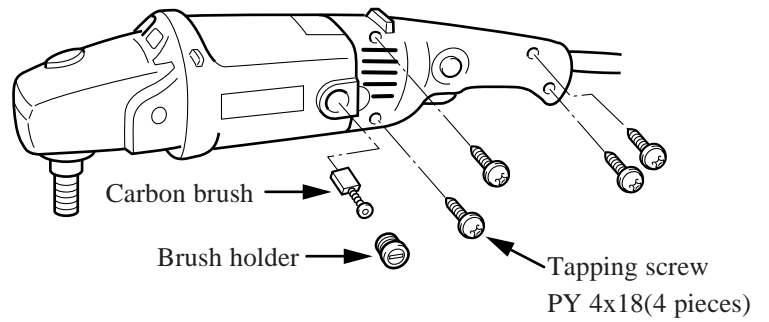

- 4) Disconnect the E ring from the armature shaft and then remove the magnet sleeve.
- 5) Disconnect one body of gear housing and armature from the motor housing.
- 6) Remove the tapping screw CT 4x16 for holding the bearing box.
- 7) Remove the pan head screws M5 x 12 and M5 x 16 for holding the bearing retainer and then pull out the armature.
- 8) To assemble the armature on the gear housing, make fit the guide of bearing retainer of gear housing on the protrusion of the bearing retainer before assembling.

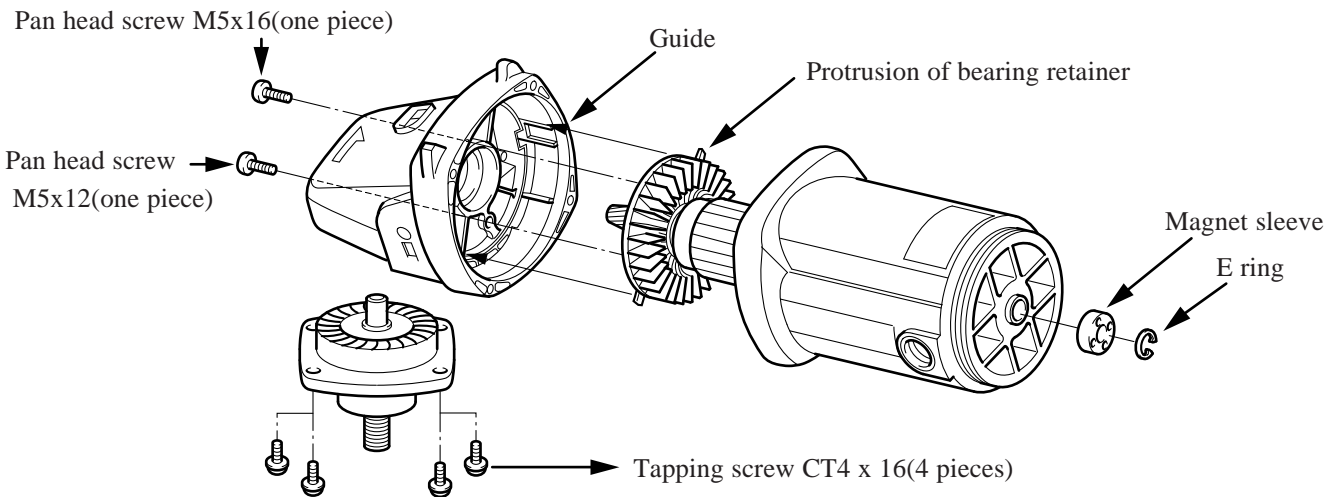

(2) Replacing methods of spiral bevel gear 52

- 1) Disconnect the magic pad.
- 2) Disconnect the tapping screw CT 4 x 16 for holding the bearing box.
- 3) The spiral bevel gear 52 is inserted into the spindle through pressing.  
Disassemble it as shown on the below figure.

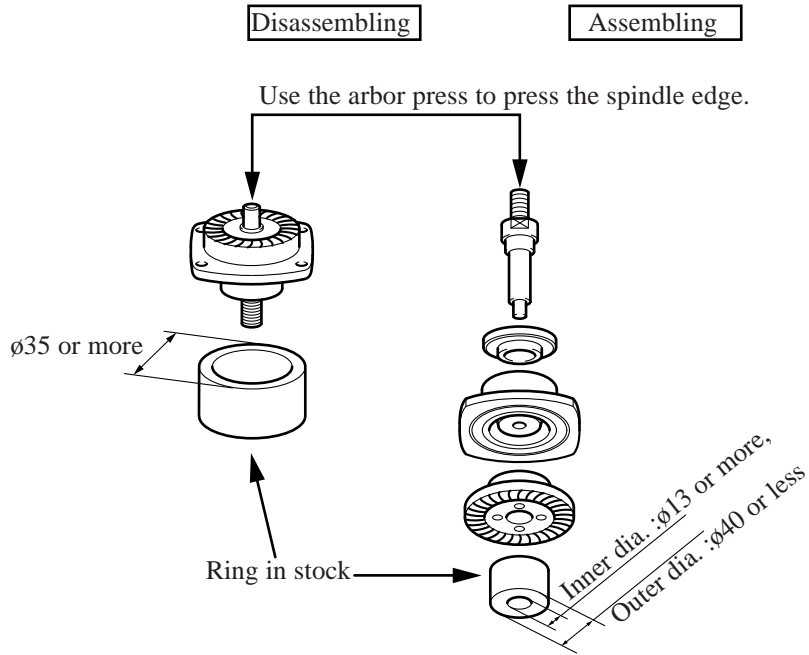

► **Circuit drawing**

The chalk coil and condenser are not used in some countries.

