

TECHNICAL INFORMATION



PRODUCT

P 1 / 5

Models No. ▶ 9564VCL, 9565VCL

Description ▶ Angle grinder 115mm (4-1/2") / 125mm (5")

CONCEPTION AND MAIN APPLICATIONS

The above models are low speed version of Model 9564CV and 9565CV, equipped with speed control dial.

The plastic head cover making it easy to grip gear housing, is required for stonework.

The wide rpm. range (2,000 - 6,800 rpm.) provides you not only fine grinding work but also ideal sanding application.

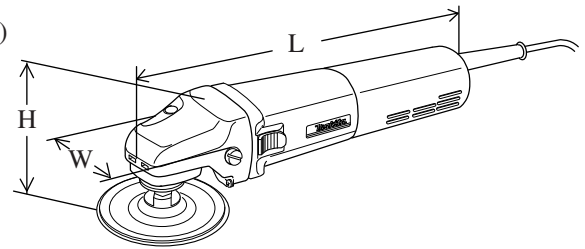

Dimensions : mm (")	
Model No.	9564VCL, 9565VCL
Width (W)	80 (3-5/32)
Height (H)	114 (4-1/12)
Length (L)	311 (12-1/4)

Specification

Voltage (V)	Current (A)	Cycle (Hz)	Continuous Rating (W)		Max. Output(W)
			Input	Output	
100	15	50 / 60	1,400	840	2,000
120	12	50 / 60	1,400	840	2,000
220	6.7	50 / 60	1,400	840	2,400
230	6.4	50 / 60	1,400	840	2,400
240	6.1	50 / 60	1,400	840	2,400

Specifications	Model No.	9564CVL	9565CVL
Abrasive disc : mm (") in diameter		115 (4-1/2)	125 (5)
No load speed : (min -1= rpm)		2,000 - 6,800	
"Super joint system-S J S"		Yes	
Electronic	Current limiter	Yes	
	Speed control dial	Yes	
	Soft starter	Yes	
	Constant speed	Yes	
Cord length : m (ft)		2.5 (8.2)	
Net weight :Kg (lbs)		1.8 (4.0)	

Standard equipment

for Model 9564VCL

- * Pad 115mm of hook and loop type 1 pc.
- * Lock nut wrench 1 pc.
- * Grip 36 assembly 1 pc.
- * Hard cover 1 pc.
- * Abrasive disc 115-60 (Hook and loop type) 1pc.
- * Wheel cover 1 pc.
- * Inner flange 1 pc.
- * Lock nut 1 pc.

for Model 9565VCL

- * Pad 125mm of hook and loop type 1 pc.
- * Lock nut wrench 1 pc.
- * Grip 36 assembly 1 pc.
- * Hard cover 1 pc.
- * Abrasive disc 125-60 (Hook and loop type) 1pc.
- * Wheel cover 1 pc.
- * Inner flange 1 pc.
- * Lock nut 1 pc.

< Note > The standard equipment for the tool shown may differ from country to country.

Optional accessories

For Model 9564CVL

- * Rubber pad 100
- * Lock nut 14-48
- * Abrasive disc 115-24, 30, 50, 80, 120
- * - ditto - (Hook and loop type)115-40, 60, 80, 120, 180,
- * Wire cup brush 90 set
- * Wheel cover for wire cup brush 90
- * Dust collecting wheel cover

For Model 9565CVL

- * Rubber pad 115
- * Lock nut 14-48
- * Abrasive disc 125-24, 30, 50, 80, 120
- * - ditto - (Hook and loop type)125-40, 60, 80, 120, 180,
- * Wire cup brush 90 set
- * Wheel cover for wire cup brush 90
- * Dust collecting wheel cover

► Repair

<1> Replacing spiral bevel gear 11

- (1) Remove tapping screw 4x18 and detach rear cover from motor housing.
And remove carbon brush as illustrated in Fig. 1.
- (2) Remove tapping screw 4x28 and detach gear housing from motor housing.
And remove armature with gear housing cover as illustrated in Fig. 1.

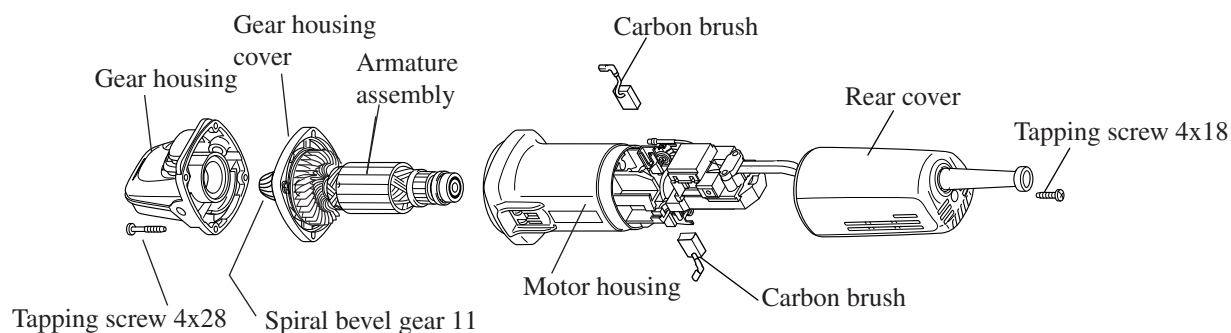

Fig. 1

- (3) Detach retaining ring S-5 and flat washer 6 from armature as illustrated in Fig.2.

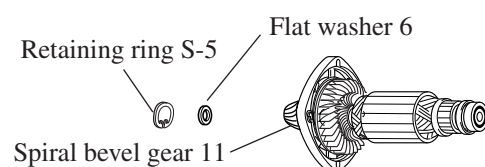

Fig. 2

- (4) Remove spiral bevel gear 11 with bearing extractor No.1R269. And remove lock spring 12 by turning it anti-clockwise. When removing, grip lock spring 12 with gloved hand for anti-skid.

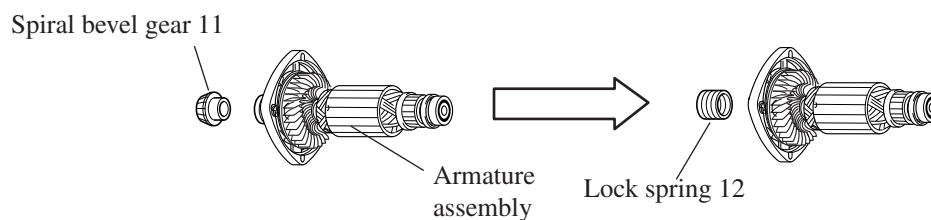

Fig. 3

< Note > Replace lock spring 12 and retaining ring S-5 as a set, when replacing spiral bevel gear 11.

- (5) When assembling spiral bevel gear 11 to armature, take the reverse step.

Attaching carbon brush

Connect the receptacle of carbon brush with the terminal of brush holder by pushing in the direction of the arrow, as illustrated in Fig. 4.

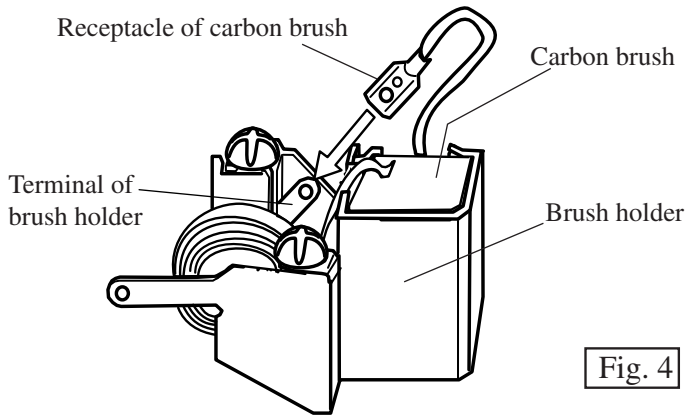

Push the receptacle of carbon brush until it stops as illustrated in Fig. 4A.

Completely attached receptacle of carbon brush

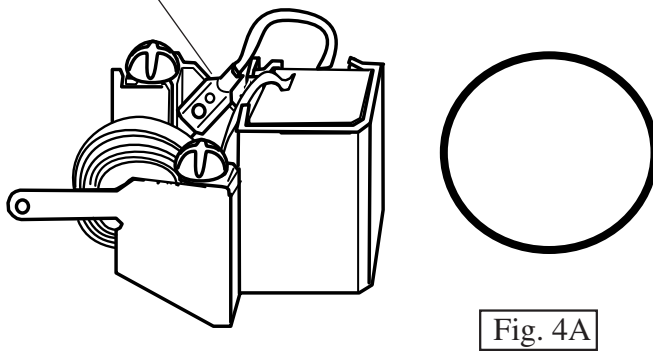

Incompletely attached receptacle of carbon brush

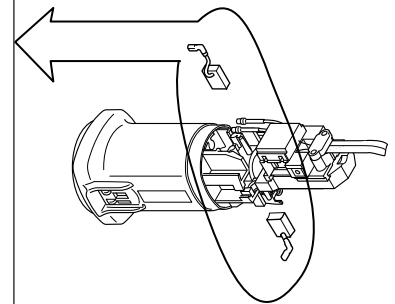
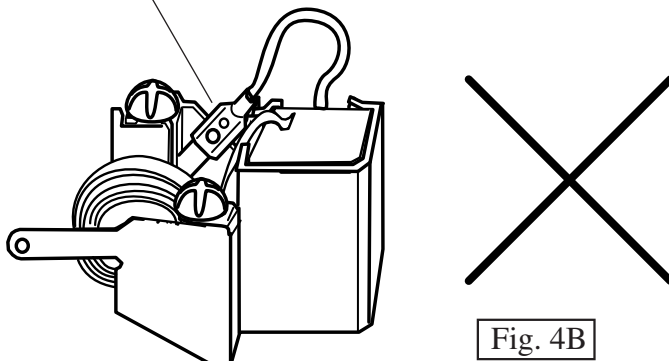

► **Circuit diagram**

Model 9564CVL / Model 9565CVL
with electronic features

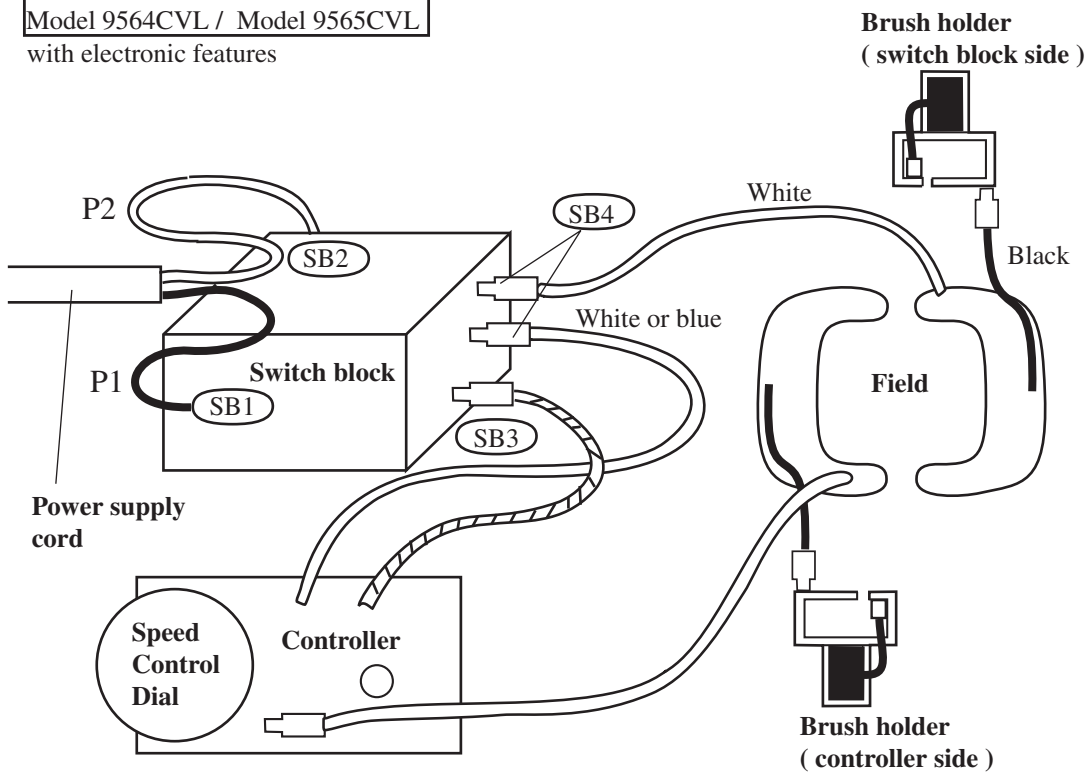

< Note >

The numbers, SB1, SB2, SB3 and SB4 are indicated on the switch block.

Fig. 4

► **Wiring diagram**

Model 9564CVL / Model 9565CVL

Put the lead wires of controller in the lead holder so that they are not slacken.

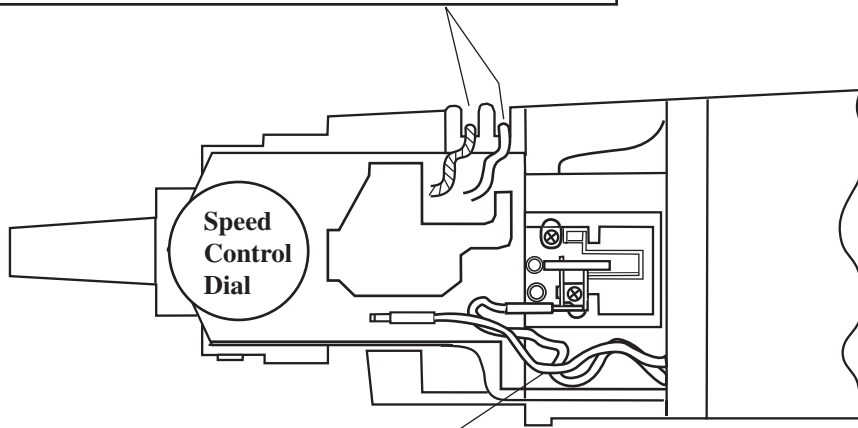

Be careful not to loosen the lead wires of field in motor housing
Put the loosened lead wires in the above place.

Fig. 5

Model 9564,CVL / Model 9565CVL

with electronic features

Put lead wires of power supply cord by strain relief as illustrated in Fig. 8.

Do not loosen the lead wires of filed in motor housing.
Put the loosened ones in the place as illustrated in Fig.8.

Fix lead wires of controller with lead holder.

Put their slack part in the place as illustrated in Fig.8.

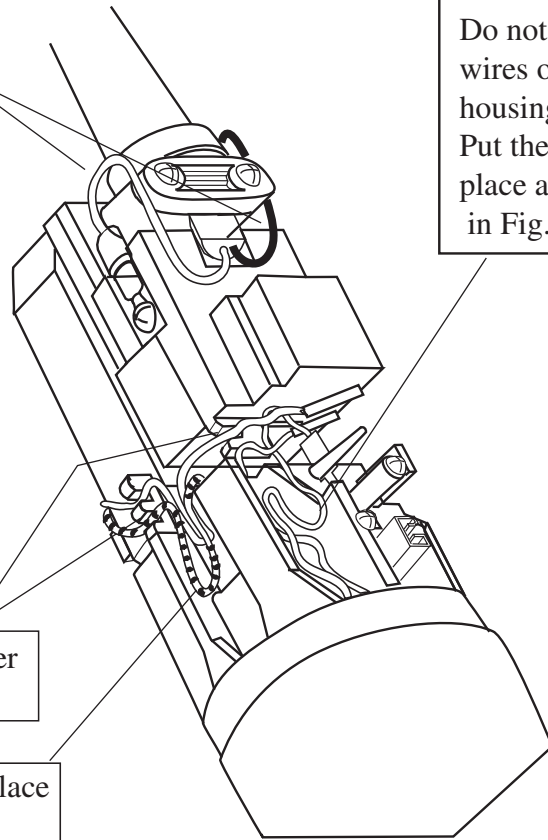

Fig. 6